

Washing the Clutch Release Bearing

A simple one this, but a common problem.

If you wade in deep water or wet mud the Bell Housing fills with mud. The Clutch Release bearing slides on a shaft and the mud stops it. On the SJ series this was pretty much terminal as the access is limited to a small timing hole and the tinplate at the bottom. This makes it really difficult to clean.

The good news is that this task is simpler on a Jimny. The diagram below shows the overall clutch mechanism and parts 1 and 11 are the cable mounting and removable cover which can be found under the car on the drivers side (UK), halfway up the bellhousing.

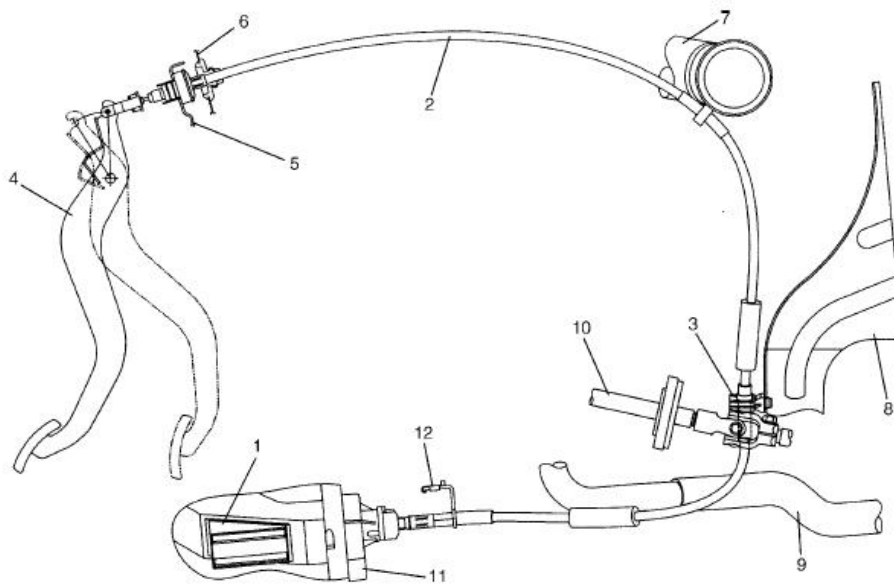

Simply prise of the cover (1) by using a large, flat bladed screwdriver.

With the cover removed the clutch release arm is exposed and you can reach a low pressure spray inside and clean the shaft and bearing.

I used a Garden Sprayer and also lightly lubricated the shaft afterwards, although it is possible that lubricant will encourage mud/dust to stick in the future.

The picture below shows the cover removed.

